

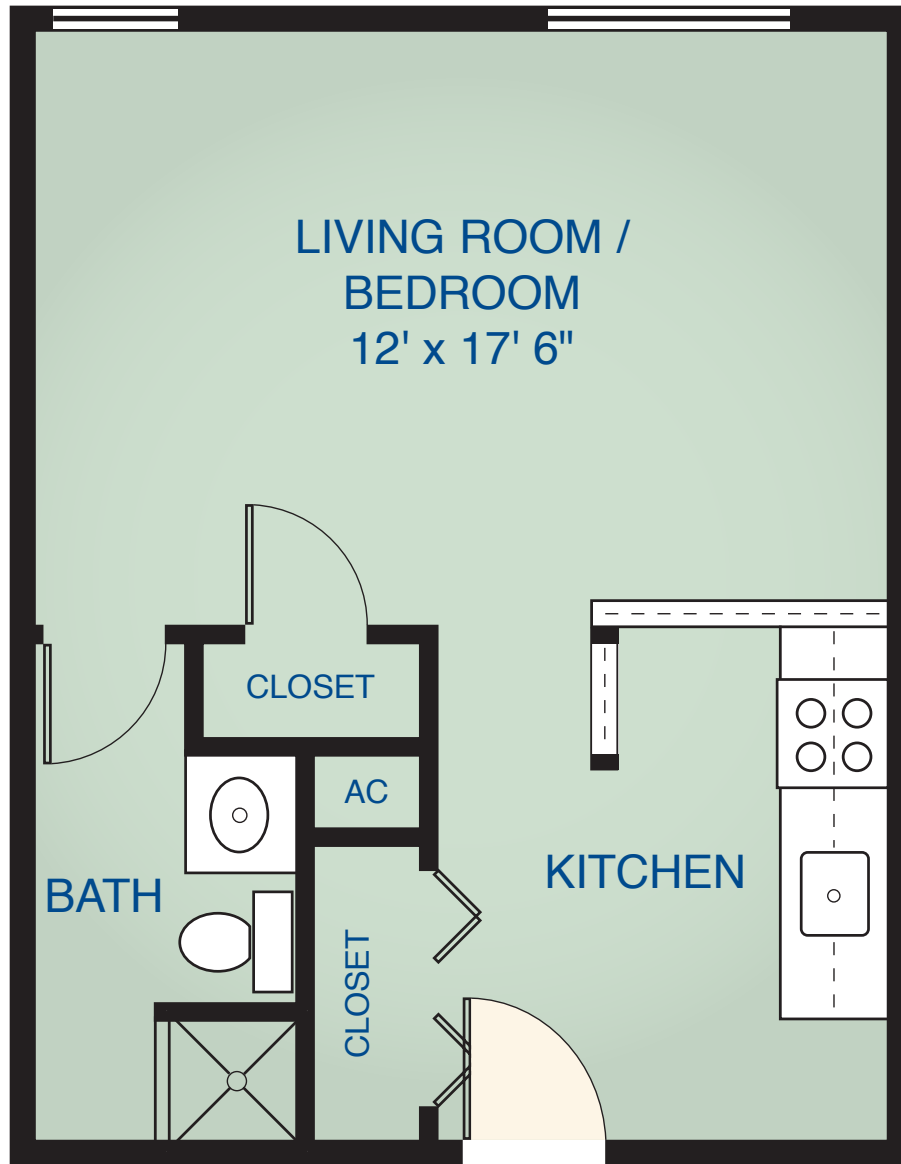

**BUCKNER**<sup>®</sup>  
WESTMINSTER PLACE  
Inspiring happiness.<sup>™</sup>



435 sq ft

# THE AZALEA

INDEPENDENT LIVING – STUDIO

INDEPENDENT LIVING | ASSISTED LIVING | MEMORY CARE | SKILLED NURSING  
2201 HORSESHOE LANE, LONGVIEW, TEXAS 75605 | [BUCKNERWESTMINSTER.ORG](http://BUCKNERWESTMINSTER.ORG) | 903.234.0000

# INDEPENDENT LIVING

Buckner Westminster Place offers a wide range of services and amenities to make your life more convenient, comfortable, and enjoyable.

## SERVICES

- Complimentary continental breakfast
- Daily noon and evening chef-prepared meals
- All utilities except telephone
- Cable television
- Interior/exterior maintenance and groundskeeping services
- Scheduled transportation
- Weekly housekeeping
- Weekly linen service
- 24-hour staffing
- Scheduled life enrichment activities
- Chaplain services
- Health club membership to Institute for Healthy Living
- Onsite IT/computer support
- Grocery delivery services

## APARTMENTS

- Apartment and patio homes with remodeled kitchen and bathroom, wall-to-wall carpeting, window blinds and limited customizations
- Fully applanced kitchens
- Individually controlled heating and air-conditioning
- 24-hour emergency response system
- Carports
- Audio-visual fire alarm and sprinkler system
- Wireless internet



**BUCKNER**  
WESTMINSTER PLACE  
Inspiring happiness.™

## AMENITIES

- Attractive main dining room
- Walking trails with fountains
- Gardens and gazebo areas
- Stocked fishing pond
- Library/computer center
- Chapel
- Salon and Barber Shop
- Manicure/pedicure spa
- Private catering and meeting rooms (available upon request)
- Free laundry facilities
- Lounge areas and game rooms
- Onsite wellness center/gym
- Arts/crafts activity center
- Guest apartment
- Reserved parking
- Movie theater/media room
- Bistro
- Billiards room



AL LICENSE #100157

INDEPENDENT LIVING | ASSISTED LIVING | MEMORY CARE | SKILLED NURSING  
2201 HORSESHOE LANE, LONGVIEW, TEXAS 75605 | [BUCKNERWESTMINSTER.ORG](http://BUCKNERWESTMINSTER.ORG) | 903.234.0000